

Supporting Documentation

Siddington All Saints – Organ

Note to parish

This bundle includes all the supporting documentation to your faculty application as required under Rule 5.5 of the Faculty Jurisdiction (Amendment) Rules 2022.

List of documentation

Item	Description	Page
<i>Overview</i>		
1	Schedule of Works or Proposals from the Petition for Faculty logged 14 November 2022	2
2	Statement of Significance and Needs dated October 2021	3
<i>Proposals</i>		
3	Drawing number 3097.10.1 of Graham Holland Associates dated May 2022	17
4	Work Schedule and Specification of Philip Cartwright dated 10 June 2022	18
<i>Correspondence</i>		
5	Email correspondence between DAC office and parish dating from 7 October 2021 to 2 August 2022	25

Caroline Hilton, DAC Secretary

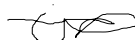

16 December 2022

We petition the Court for a faculty to authorise the following-

Please describe the works or other proposals for which a faculty is sought in the way recommended by the Diocesan Advisory Committee in its Notification of Advice.

SCHEDULE OF WORKS OR PROPOSALS

The addition of a new detached console and tonal additions to the existing organ. It is to be positioned in front of the chancel screen on the north side. It will have the same specifications as the existing console, but also augmented with playing aids to encourage non-organists to play. The case of the new unit will be styled and stained to match the existing church furnishings. No pews will need to be removed, as it will replace the existing rather old electric piano.

Copies of the Standard Information Form and any drawings, plans, specifications, photographs or other documents showing the proposals must be provided with this petition.

21, West Bank Road,
Macclesfield,
Cheshire
SK10 3BT.
01625 617027

October 5th 2021.

Diocesan Advisory Committee,
Church House,
Daresbury,
Warrington. WA4 4GE

PROPOSAL TO MOVE THE EXISTING ORGAN CONSOLE AT ALL SAINTS' CHURCH, SIDDINGTON. (Parish No 1324.)

Dear DAC,

We wish the DAC to consider the possibility of All Saints' Church, Siddington moving the organ console and pedals into the main body of the church from its current position in the singers' gallery.

The following is minuted from the PCC meeting held on September 15th 2021:

"Organ – A proposal was made that the Diocese should be approached for permission to consult the Organ Advisor regarding the repositioning of the console and pedals into the main body of the church, possibly where the electric piano is currently placed. Agreed unopposed."

Yours sincerely,

Sheila Kent (Hon Secretary.)

Statement of Significance for Siddington Church October 2021

All Saints' Siddington is a Grade 2* listed, timber framed church building. The date of foundation is unknown, but thought to be sometime in the 14th or 15th century. The timber frame of the nave is enclosed by brickwork dating from 1816, with the timber pattern repainted on the nave interior. The nave is divided from the chancel by a medieval screen. The chancel is not bricked, and timbers remain visible internally and externally.

The windows of the nave were changed in 1816, the chancel windows remaining as previously. Seating is 'Victorian' pews, in both nave and chancel. The 'choir stalls' in the chancel are reported as having been family pews for the families of Capesthorpe Hall on one side and Thorneycroft Hall on the other. Total seating capacity of nave and chancel is approx. 140. It is likely the pews, pew blocks and tiled floor date from 1853 when we believe the present font was installed. The current pews have features reflecting those furnishings which were in place in a picture from 1840.

The west end of church has a singers' gallery, erected we believe in 1780. The panelling at the west end of church beneath the singers' gallery appears to be of a date with the pews, slightly different to the panelling on the gallery itself. The panels behind the pews incorporate 2 cupboards, one of which houses a small sink and hot tap. Two memorial boards hang on the rear panels recording donations to the church.

An organ was first installed in the singers' gallery in 1867. According to the church archives this was a Nicholson and Lord single manual instrument. In 1899 the same firm incorporated the pipes and wind chest of this into a two manual organ, described as "practically new" in a letter of that year held by Chester Record Office. Although an electric blower was installed in 1945 the hand-operated lever was retained. The organ's current position is illustrated in this photograph. (It shows the church decorated for Harvest with over 1,000 corn dollies.) The organ itself is also pictured.

Music is an important part of worship at All Saints, Siddington. There is a robed adult choir, with recently expanded numbers and a wide age range. The congregations usually join in the singing with enthusiasm. The person playing the organ most regularly is a professional musician.





The following description of the organ is taken from the NADFAS survey of the Church:

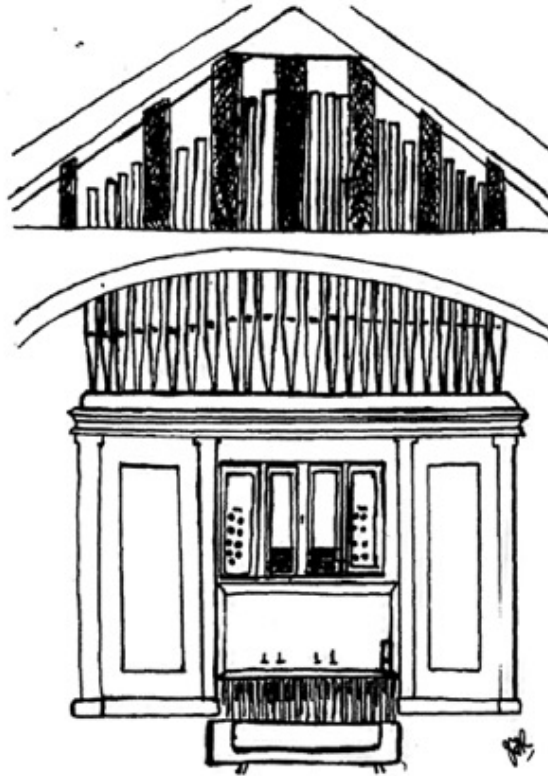

ORGAN AT ALL SAINTS, SIDDINGTON.

Description:

This is a small organ of two manuals and pedals. The whole organ is housed in a wooden case or chamber with side panels. The pipe display consists of 23 pipes mounted on a wooden base above the top beam with a straight cross beam on top of which are seven square wooden posts connected to the wooden roof arch.

The console is mounted below a finial which is supported at either side by a square chamfered wooden pillar. The two manuals, each comprising 54 notes - CC to F, are centrally mounted and projecting from the console. At each side of the manuals is a panel containing the draw stops and couplers, and there is a rectangular wooden pillar outside each stops panel. The manuals and stop panels are enclosed by wooden, double-hinged, glass panelled doors with mortice lock. On the outside of each of the pillars adjoining the stop panels is a rectangular wooden panel and a further pillar. Above the upper manual an ivory plaque (h. 4cm. x w. 10cm.) is affixed to the organ, and is inscribed in black sans serif caps.: NICHOLSON & LORD / WALSALL.

The stops and couplers are draw knobs with round wooden shanks and ebony knobs. The knobs have ivory discs engraved in black sans serif caps. Below the manuals is a wooden panel in which there are four metal pedals, the left two operating (one opening and the other closing) a combination of draw knobs on the Swell Organ, and the right two operating similarly on the Great Organ. To the right of the panel, and mounted at an angle, there is a swell pedal. The organ has an electric blower, but retains the former hand blower and the original mechanical tracker action for the keys. The pedal organ has tubular pneumatic transmission action. At the base is a straight, flat pedal board comprising 30 notes CCC to F. There is a separate one step wooden bench seat.

Statement of Needs

The singers'/organ gallery is approached by a steep set of stairs, with a twist at the top. (See pictures).





Whilst there is a hand-rail it is difficult to negotiate, and although there are several good organists within the Benefice, and indeed within the Parish itself, the number prepared to ascend and descend this staircase is very limited indeed. This means that since the retirement of the previous organist in July, finding someone to play when the person who has largely taken over is unavailable is difficult.

The access door to this gallery is blocked when the West Door of the church is opened for weddings and funerals, but more regularly recently because of the Covid pandemic. On one occasion a wedge had been used to secure this door opening for well-intentioned safety reasons, requiring the organist to hammer on the door to exit from the gallery to take Communion.

Interestingly, in their letter in the Chester Record Office, mentioned earlier, written in 1899, Nicholson and Lord say that the space to insert a two manual organ in the gallery is limited, and the NADFAS chairman's letter explains that they do not have a picture of the organ because of the difficulty of access. Extracts from both letters are given here.

CHESTER RECORD OFFICE:

**TRANSCRIPT OF LETTER TO MR. W.H. WEBB, SIDDINGTON
FROM NICHOLSON & LORD, ORGANBUILDERS, WALSALL
DATED 5TH MAY 1897:**

Referring to our visit to your Church to examine your Organ we have pleasure in enclosing a Specification and Estimate for what is practically (?) a New Organ with two Manuals & Pedals Organ, the present Organ being worked in the new instrument so far as the pipes & wind(?) chest is concerned as the fuse, bellows and action will not be of any use.

We find that the space to insert a 2 Manual Organ is limited in the West Gallery - It can be placed there and it is the only place in the Church suitable but the front of the Gallery will have to be brought out about 2ft 4 in about 8 ft of width for the Organist to sit and for the Choir to pass as the Organ itself will take up all the space from front to back on the ground floor & the front will have to be coved(?) over and brought out in front of the beam that overhangs the Gallery.

We have sent a Specification with what we consider to be the most suitable stops for the Church. We have inserted a Gamba stop in the Swell Organ in preference to an Oboe because it will keep in tune better and this is an object in a place that is somewhat difficult of access.

We should be pleased to tune the Organ and you may rely upon having a first-rate instrument in every respect. We are, Dear Sir,

Yours faithfully,
Nicholson & Lord

To Mr. W. H. Webb
Siddington & Chelford.

SPECIFICATION & ESTIMATE, dated 5th May 1897

The sum of £195, Less £25 for 'working in' the present Organ.

N.B. FINAL ACCOUNT; dated October 4th 1899

£195. 0. 0	-	For One Organ as per Specification & Estimate dated May 5th 1897
£3. 0. 0	-	To carrying wind chests & pipes up to G in alt instead of F
£1. 5. 0	-	One ship(?) Organ bench

£199. 5. 0
7. 5. 0 (discount)

£192. 0. 0

Paid on Nov. 5th 1899.

JUNE 1923: An estimate was obtained from Nicholson & Lord for complete overhaul of the Organ, the cost being £32, there was no evidence of this being carried out.

GRADE II* LISTING: Refs: SJ 87 SW

6/98
14.4.67
CU

Brampton Cottage, Whisterfield Lane, Siddington,
Macclesfield, Cheshire SK11 9LF
Tel: 01260 224295 - Fax: 01260 224462
E-mail: margaret.lukeman@lineone.net

Andrew Argyrakis
Conservation Officer
The Church of England Archbishops Council
Church House
Great Smith Street
London SW1P 3NZ.

4th April 2001

Dear Mr Argyrakis

SIDDINGTON, All Saints, Cheshire (Chester): Organ

Thankyou very much for your letter of the 30th January in response to my enquiry. I am sorry it has taken so long to reply to you, but I have had to do a bit of research, and, of course, also wait for a P.C.C. meeting. I am now able to answer your questions regarding the history of the Organ, as follows:

1. The Organ was built by Nicholson & Lord of Walsall in 1899. According to their Specification & Estimate, dated May 5th 1897 the pipes and wind chest of the previous organ, which was a single manual and also built by them and dated 1867, were incorporated into the new organ.
2. The present stoplist is:

Swell Organ	Fifteenth 2ft	Gemshorn 4ft	Quartane II Rks	Salcional 8 ft
	Lieblight Gedact Treble 8ft		Lieblight Gedact Bass 8ft	
Great Organ	Principal 4ft	Lieblight 4ft	Clarabella with Stopt Bass 8 ft.	
	Open Diapason 8 ft			
Pedal Organ	Bourdon 16 ft Bass Flute 8 ft			
Couplers	Swell to Pedals Swell to Great Great to Pedals			
3. i. In 1923 a specification & estimate was obtained from Nicholson & Lord for overhauling the organ, but we do not have evidence if this was carried out.
ii. An electric blower was installed in 1945, but the hand-operated lever and bellows were retained.
iii. In 1970 the organ was overhauled.
4. M.J. Syson, M.P.T.A., M.I.M.I.T., of Milton, Stoke-on-Trent, Staffs.
5. Due to the difficulty of access we do not have photographs, but I am enclosing a detailed drawing of the Organ, made by the Nadfas Recorders. Also attached is the description of the Organ taken from the Nadfas Record, which was made in 1997.

We are currently planning to have other works carried out in the Church, as follows:

1. Following investigation, i.e. the removal of plasterwork in the South Nave, it may be necessary to carry out repairs/ remedial work to the timber frame of the building.
2. Repairs/ remedial work on windows in the Vestry.

The organ has recently been surveyed by the Chester Diocesan Organ Advisor, Roger Briscoe, but to date we do not have his report. However, verbally, he recommended that the suggested complete overhaul certainly ought to be carried out as the Organ was in very good condition for its age and well worth retaining. We estimate that the total cost of the work will be around £11,000. As soon as we have Mr. Briscoe's report I will, if you wish, forward a copy to you.

The organ stands in front of the West Window, which required major repair in 2001. As the organ needed to be dismantled to do this the opportunity was taken to consult the Diocesan Organ Advisor, Roger Briscoe. As a result the organ was overhauled by Peter Collins, but also there was what is described in the DAC notice as "minor repositioning" to allow improved access to the organ pipes etc for tuning. The unanticipated result of this repositioning is that access to the far side of the organ is

now very narrow indeed, (see picture), as the organ stool is still the particularly heavy one mentioned by Nicholson and Lord and so cannot readily be moved.



This far side is one of the few storage areas in church apart from a very small vestry, and anyone trying to move to that side has to squeeze past a waist high gallery rail.



Sadly, in spite of our best efforts to stop them, some people feel that the best route therefore is to walk across the organ pedals, risking damage.

In 1994 an electric piano was placed in a wooden cabinet in the chancel against, (but not impacting on), the screen, (please see the picture.)



Created with Scanner Pro

PROPOSED REPOSITIONING OF
ORGAN CONSOLE, OCTOBER 2021, TO REPLACE CURRENT
ELECTRIC PIANO.

Siddington, All Saints;

Aug 30 2021 7:47

**GRAHAM
HOLLAND
ASSOCIATE**

Architects & Historic Buildings Consultants
4 King Street, Exeter, Devon EX1 1AA
Tel: 01392 551100 Fax: 01392 551101
Mobile: 07885 200208
Plan, Draw, Make, Photograph, Sell
all rights reserved for 2021
www.grahamholland.co.uk

The drawing includes a photograph of the exterior of Siddington, All Saints Church, showing its stone construction, gabled roof, and three prominent windows. Below the photo is a detailed floor plan of the church interior. The plan shows a nave with a central aisle, side aisles, and a choir. A north arrow is located in the bottom left corner. Text on the plan includes 'north', 'Floor plan 1:50 @ A3', and 'do not scale. this drawing should not be used for construction without the aid of the original drawing'. A section of the plan is labeled 'S.E. 101' and 'S.E. 102'.

north
Floor plan 1:50 @ A3
do not scale. this drawing should not be used for construction without the aid of the original drawing

Sent from my iPad

16 of 28

Sladdington, All Saints;

New Organ console

May '22

dwg no 3097-10-1

GRAHAM
HOLLAND
ASSOCIATES

Architects & Historic Buildings Consultants
Winnington Hall, Cheshire, CW8 4DU
tel: 01606 624626 fax: 01606 74002
mobile: 07885 224256
Plas Draw, Ruthin, Denbighshire LL15 1RT
tel: 01824 704709 fax: 01824 704912
email: info@grahamhollandassociates.co.uk

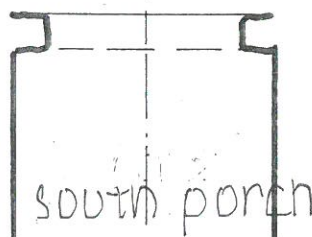
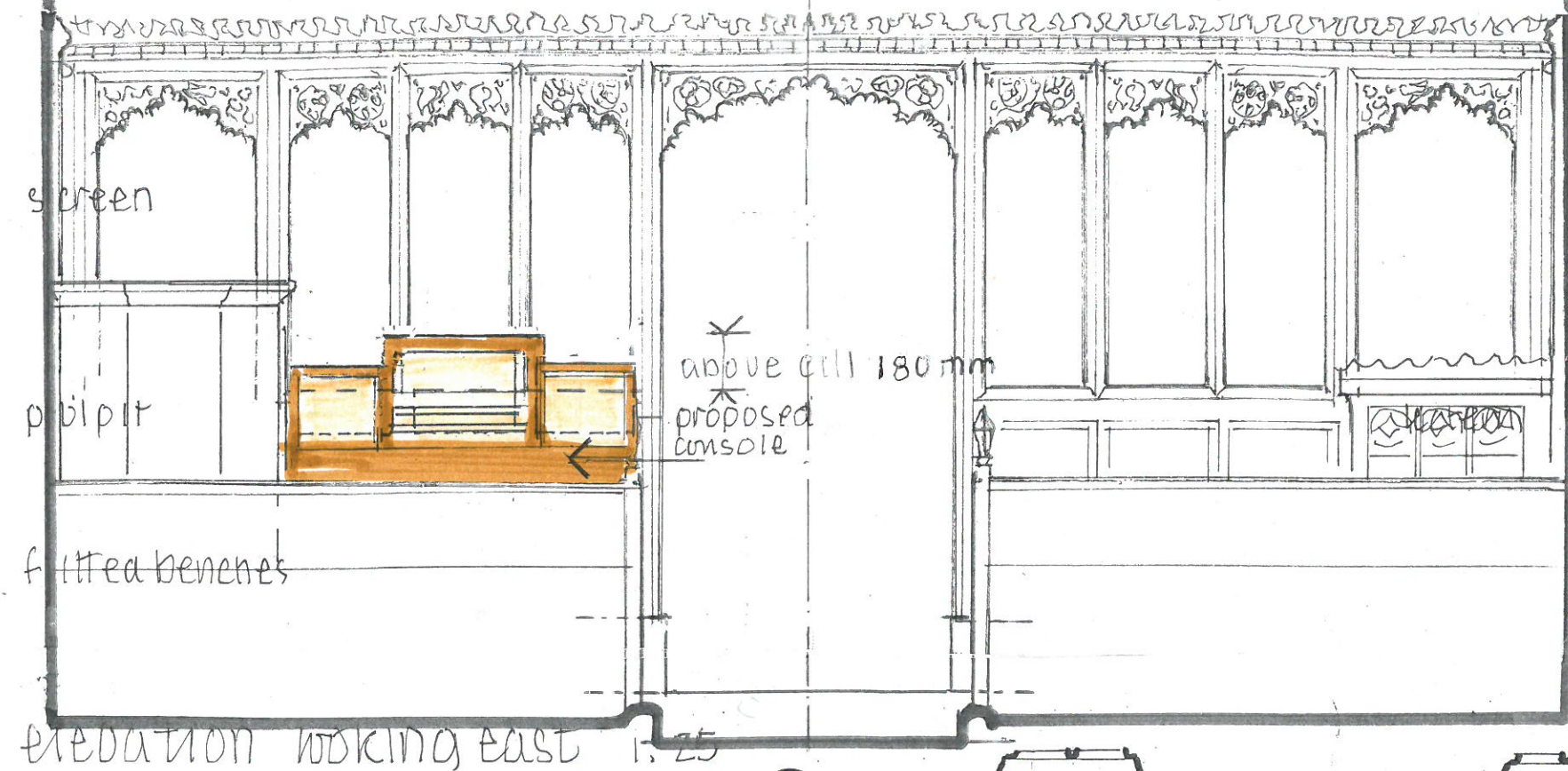

north

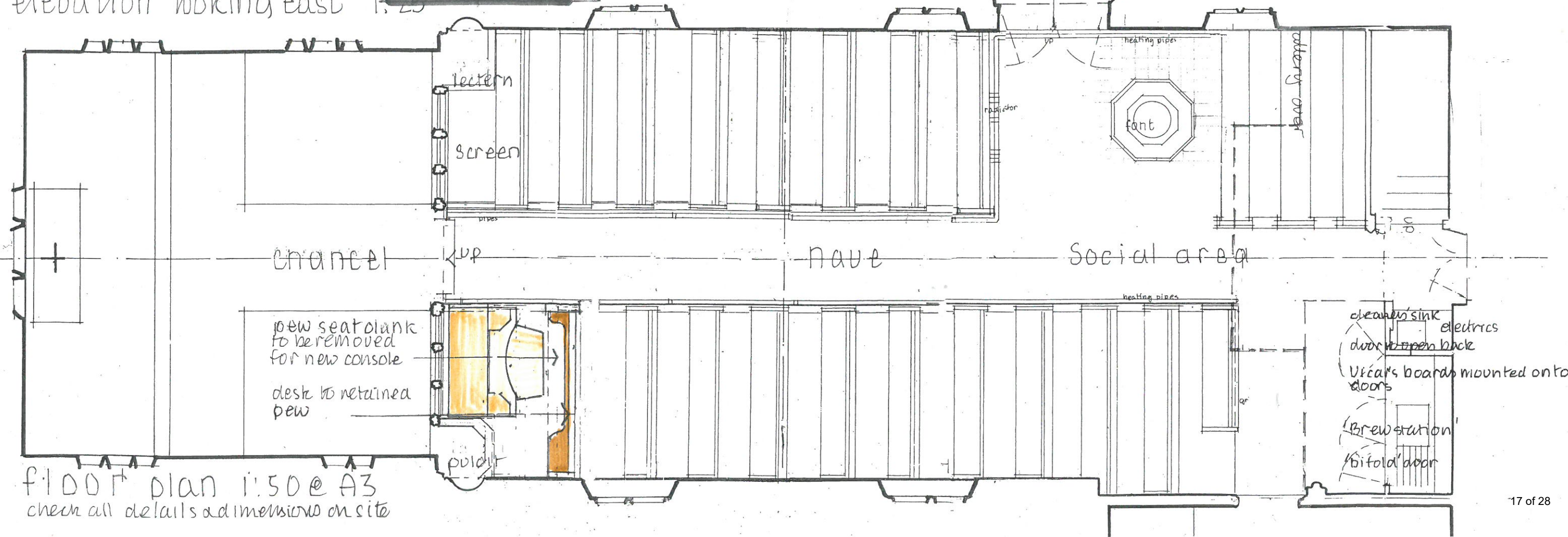

CARTWRIGHT & CARTWRIGHT

ORGAN BUILDERS

19, ST GEORGE'S AVENUE SOUTH,
WOLSTANTON,
NEWCASTLE UNDER LYME,
STAFFORDSHIRE.
ST5 8DB
WORKSHOP:- EASTFIELDS FARM,
MEADOW LANE,
SLINDON,
STAFFORDSHIRE.
ST21 6LX.

07971 326112. jtkpcartwright@aol.com

10th June 2022

The Vicar and Churchwardens,
All Saints Parish Church,
Siddington,
Cheshire.

Dear Sirs/Mesdames,

All Saints Parish Church, Siddington, Cheshire.
Work Schedule and Specification to Provide a New Detached Console and
Tonal Additions to the Organ.

A new detached drawstop console is to be provided and positioned in the nave in front of the chancel screen on the north side. It will be finished and stained to match the existing furniture and fittings and will incorporate drawstops set into 45 degree jambs, a new 30 note RCO standard pedalboard, excellent quality refurbished keyboards and a new height adjustable, full length bench.

The new console will have the same specification as the present console but will be augmented and furnished with playing aids to assist and encourage “non organists” to play namely a Pedals to Manuals coupler and a General Crescendo pedal.

When the Pedals to Manuals coupler is drawn the bottom note of a chord played either on the Swell or Great will play the relevant pedal note without the need to play the pedals. In addition when the coupler is drawn it will isolate the pedals so the player's feet can rest on the same.

To remove the need to operate the stops whilst playing, the General Crescendo pedal can be used. It will control the two manuals and the pedals and when

operated will select stops ranging from “piano” to “forte” depending on the position of the pedal.

A capture piston system will be incorporated into the console along with thumb and toe pistons detailed in the included specification. The capture piston system will have 8 memory levels enabling different organists to save their own piston settings and will have a digital display at the console.

A MIDI interface will be incorporated in the console to enable recording and playback of MIDI files on the organ. For example if the organist can not be present at a service he or she can pre-record hymns and perhaps a voluntary on to a laptop and a “non organist” can play the files back during that particular service.

All stop, key, and pedal inputs will connect into a micro processor which will send a digital signal to the organ in the gallery via a CAT 5 cable. The blower will be operable from the new console via the same cable and a relay in the organ.

To render the organ compatible with the detached console the present tracker manual actions will require the addition of an electric lever solenoid on each of the 112 keys. Each drawstop slide would be fitted with a slider solenoid (there are 10 in total). The Pedal action is at present exhaust pneumatic and will require 42 pallet magnets and exhaust rails fitting to the actions to enable the pneumatics to operate from the new console. The Swell pedal is also mechanical and would have to be fitted with an electric motor stage engine. All electric actions will be connected to 3 electronic output boards which receive and distribute the signals from the console.

The present console is difficult to access with having to negotiate the narrow, turning staircase and thus, along with the case being brought forward during the last rebuild limiting the distance between the organ and gallery front, makes playing quite an unnerving experience.

The proposed detached console and peripherals will allow the organ to be played confidently by pianists and keyboard players from the much safer position at ground level.

Work Schedule

Console.

A new, oak, detached, rolltop drawstop console is to be custom made to suit the proposed site on front of the chancel screen on the north side of the nave facing east. The case will be styled and stained to suit and match the existing church furnishings.

Stop Control. The console will be fitted with 45 degree jambs and drawstops. The knobs will be turned wood with ivory resin disc inserts.

The pedalboard will have an oak frame with pedals of maple and be fitted with a pedal sweep to accommodate the pedal jack type contacts.

Toe piston sweeps will be added to the pedalboard and be fitted with brass toe pistons as per the specification. Engraved identification discs will be fitted next to each toe piston.

The keyboards will be drawn from our used stock and be fully refurbished with new felts and electric contacts/wipers. Engraved thumb pistons will be fitted as per the specification.

Two centrally located pedals will be fitted in the normal position to operate the Swell box and the new general crescendo facility. The general crescendo will switch a selection of stops from pianissimo when the pedal is shut to fortissimo when the pedal is open.

A new custom built micro processor control will be installed in the console into which the keyboards, stops and pedals will be connected; this will control the organ and the new capture piston system. Thumb pistons and toe pistons will be added to the keyboards and pedalboard respectively according to the specification. A piston memory level adjusting switch and display will be fitted into one of the jambs along with a keyswitch to operate the blower.

A MIDI interface unit will be fitted and MIDI leads will be provided.

A new, height adjustable oak bench will be provided and finished to match the console.

The capture piston system control panel consisting of a digital display and rotary 36 memory switch will be fitted at the foot of the right hand stop jamb.

All equipment will be wired via neat looms into the micro processor input boards inside the console and a low voltage 30A DC power supply will be fitted.

Two leads (approximately 8mm in diameter) will come out of the left hand side of the console at floor level; one 240V mains power lead to the console and one CAT5 output cable to the organ.

The CAT5 cable will run from the console up the wooden pillar and run down the church on top of the north wall under the eaves and emerge in the gallery where it will pass down the wall in the rear corner and across the floor to the bottom of the organ case.

Organ.

The present console will be left intact. The interior of the organ will be dismantled enough to give access to reach all the actions.

The manual rollerboards, pulldowns, trackers, leverbeams, squares and couplers will be removed and set to one side. Scales will be taken and two new polished 1" birch ply solenoid boards will be cut and shaped to accommodate the new 112 Heuss heavy duty lever magnets. The boards will be fitted in the present building frame with new polished hardwood brackets.

The bronze pulldown links from the Great soundboard to the backfall levers will be removed and replaced by long 16g phosphor bronze rods looped at one end to connect to the pallet pulldowns. They will pass through the backfall levers and down through the lever solenoids. The levers and solenoids will be connected to the rod using new cloth washers, fixed and adjustable collets.

The wooden trackers from the Swell rollerboard to the cross tracker back squares will be extended below the squares to pass through the lever solenoids. Again the solenoids will be connected to the bronze rods with new cloth washers, fixed and adjustable collets.

The solenoids will be connected via new wiring looms to two electronic output boards.

To provide an electric action to the Pedal Bourdon/Bass Flute will necessitate the making of two exhaust valve rails. Each of the 42 pipe actions will have an electric pallet valve inserted in the pneumatic tubes to electrically exhaust the pipe action from the detached console whilst still enabling the present pneumatic action to operate from the present console. The rails will be of polished birch ply and be secured by hardwood brackets.

Two new platforms will be built from polished birch ply secured by hardwood brackets to accommodate the slider solenoids; one platform for the Swell and one for the Great. The solenoids will be mechanically connected to the stop levers via short cock rods and clevis pins. The solenoid inputs will be connected to an electronic output board.

A quality 56 note rank of spotted metal Fifteenth 2' pipes will be selected from our used stock and be fitted to a new direct electric action chest which will be

mounted above the present Great. This chest will be fitted with an electronic output card.

All electronic output cards will be interconnected with coaxial cable terminating a main output board which will connect to the console via the CAT5 cable.

A 50A DC low voltage power supply will be fitted to power the new electric actions.

The blower will be fitted with a relay to control the 240V connection to the mains.

All dismantled parts will be re-assembled and all adjusted to work easily and reliably.

Tonal Finishing.

The additional Great Fifteenth 2' will be regulated on site to match the existing Diapason chorus of 8' and 4'.

Quotation

The total cost to carry out all the work described would be:-

£42,930 (Forty Two Thousand, Nine Hundred and Thirty Pounds) plus VAT.

General Information

Guarantee.

The entire works as described would be guaranteed for a period of fifteen years from the date of completion during which time we undertake to make good or replace any part or parts which shall prove defective without charge to the church subject to the following conditions:-

1. A contract for the tuning and maintenance of the instrument shall be continuously maintained between us and the church and no adjustments or alterations shall be made to the organ other than by a member of our staff or with our consent.
2. Damage to the organ by circumstances beyond our control and also fair wear and tear.

Working Arrangements.

During the undertaking of the work the church will provide all reasonable facilities for the storage of any parts of the dismantled instrument and their protection against damage also the free use of water, gas, electricity and heating as available and required in connection with the undertaking of the work and reasonable comfort of the craftsmen.

Inspection and Insurance.

Every facility will be given to the church authorities to inspect the work during the undertaking where it is safe to do so.

All parts of the organ removed from the church to the workshop will be covered by the organ builder's insurance (including parts in transit). Parts remaining in the church will be covered by the insurance of the church.

Transport.

The cost of transport to and from the church is included.

Please contact me if I can be of any further assistance, indeed I would be delighted to attend any meeting.

Yours faithfully,

Philip A. Cartwright MISOB.

Proposed Specification.

Swell

Lieblich Gedact Bass	8
Lieblich Gedact Treble	8
Salicional	8
Gemshorn	4
Fifteenth	2
Quartane	II

Great

Open Diapason	8
Clarabella	8
Lieblich Flute	4
Principal	4
Fifteenth	2

Pedal

Bourdon	16
Bass Flute	8
Pedal to Manuals	

Couplers

Swell to Great
Great Octave
Swell to Pedal
Great to Pedal

Compass

Manuals CC – G 56 notes

Pedals CCC - F 30 notes

Expression

Peterson 8 Stage Engine.

General Crescendo

16 Stage.

MIDI Interface

Piston Action

4 thumb and toe pistons to Swell
3 thumb/toe pistons to Great and Pedal
Set thumb piston
General Cancel
8 position rotary memory level switch

Sw to Gt thumb and toe reverser
Gt to Ped “ “ “ “

Siddington All Saints - Organ - Correspondence with parish and others

Attachments are listed according to the numbering on the supporting documents list

- [Attachments in blue are included within the proposals section](#)
- Italic text refers to superseded or unnecessary attachments

Date	Message
07/10/2021 To: Caroline Hilton From: Sheila Kent With attachment	<p>All Saints' Church, Siddington, (1324), would like to consider moving the organ console into the body of the church as part of the project to celebrate the 500 years since the church's consecration, thus ensuring that the organ which has played an important part in the church's history for over 100 years continues to be a feature of worship in the building.</p> <p>Katy advised me to have this paperwork with your office by Friday 8th ready for the preparation of papers for the DAC meeting, and agreed to me contacting the Diocesan Organ Adviser. Our meeting with him is tomorrow (Thursday 7th).</p> <p>Thanks as ever for all the help I have received from your department.</p> <p>2) Letter of Sheila Kent dated 5 October 2021 with note of PCC resolution and Statement of Significance and Need</p>
07/10/2021 To: Sheila Kent From: Caroline Hilton	<p>Thank you for your message and the attached document for consideration by the DAC at its forthcoming meeting on 22 October. I note the visit of the diocesan Organ Adviser Andrew Mannings scheduled for today. I will forward the document you've provided to Andrew as it will be very helpful for him to be able to see that.</p>
27/10/2021 To: Sheila Kent From: Katy Purvis	<p>DAC Advice</p> <p>At the meeting of 22 October, the DAC considered the proposal to relocate the organ console wished to offer the following informal advice</p> <ol style="list-style-type: none"> 1. The Committee appreciated need for the relocation of the organ console on health and safety grounds 2. It noted the Organ Adviser had suggested an alternative location in the SE of the chancel. If the parish wished to pursue its current proposal to position the organ console where the piano is currently situated and was sure it did not wish to explore the alternative location then the Committee was content to encourage the parish to submit a faculty application for their proposal 3. The parish would also need to consider the effect of removing the pew and provide further details on that point (i.e. the provenance of the pew and what they propose to do with it)
16/02/2022 To: Katy Purvis	<p>We are now in a position to complete a faculty form for the work on the organ we were in correspondence about. Do I acquire the paperwork for this from you, please?</p>

From: Sheila Kent	
17/02/2022 To: Sheila Kent From: Katy Purvis	You need to make an online application here, https://facultyonline.churchofengland.org/ You are registered, but please let me know if you need any help at all
17/02/2022 To: Katy Purvis From: Sheila Kent	That's really good that I can use the online system, Katy! I used it for our emergency roof-truss repair and found it so much better but I was concerned that it would be back to the paper one for a job like this. We have a small glitch in the chain of information Graham needs for his drawings at our end, but we'll be on to it all as soon as we can.
03/05/2022 To: Katy Purvis From: Sheila Kent	<p>I wonder if I could have some advice, please? We have now assembled what we need for a faculty application for the DAC approved new detached console for the organ at Siddington.</p> <p>When I go onto the online application form it leads me to list A - Church Buildings, then to A2-1. ("The introduction or disposal of musical instruments (other than pipe or non-portable electric organs".) I have selected this because we are introducing only an organ <u>console</u> into the downstairs area of the church, which will then be electronically linked to the existing pipes in the gallery, which will remain fully functional. No part of the existing organ is being disposed of, and could be played if the pipes were reconnected to it.</p> <p>The organ builder and Diocesan Organ Advisor doubt if the existing pews need to be touched at all, though Graham Holland is going to make a final check of this. The only change is that the current electric piano which sits in the proposed space for the console will be portable once more rather than having a permanent space in the nave.</p>
04/05/2022 To: Katy Purvis From: Sheila Kent With attachment	<p>Here's Graham's drawings, but I must stress that he has done this without a site visit. He has included on his drawing a half pew attached to the pulpit on the side where the console is going which has never been there in the 30 plus years I have been church secretary, as there has been an electric piano there for many years, and an upright piano before that. (The DOA would be able to confirm that in his and the organ builder's view the console would fit in the available space.)</p> <p>Graham, of course, deals with a vast number of churches, and if his template for Siddington does include that it would be a simple and logical error given the position of an equivalent half pew on the other side of the nave. No work has been undertaken at the proposed location site requiring close inspection of that area of a drawing for over 30 years in just my own experience. We would be very happy to have his advice throughout the process as he is a valued part of the team at Siddington.</p> <p>I will also send you his accompanying letter and my response about that particular pews.</p> <p><i>Superseded drawing</i></p>

04/05/2022 To: Sheila Kent From: Graham Holland	<p>From the information supplied and adapting my dwgs. to hand I have prepared a draft plan and elevation of the console in situ. Note, this rises above the 'cill' of the screen – a problem?</p> <p>I assume that the console would fit reasonably close to the base of the screen and be moved away for maintenance access to the pack panels. Two pews would require to be taken out and I suggest a 'desk' be made to front the remaining.</p> <p>As advised I will need to check all details on site when I visit.</p>
04/05/2022 To: Graham Holland From: Sheila Kent	<p>I found an anomaly in the faculty form and will forward you the email I have just received. Thanks for this letter.</p> <p>I remain puzzled about why two pews might need to be removed but I think all will be clearer when you can visit? (On the pulpit side there has never been the equivalent half pew to the lectern side in all the 30+ years I've been secretary. The electric piano is over 30 years old and prior to that there was an upright in place for all the years I remember. (My wedding picture from 48 years ago might help date if there was one in place then, but I don't remember one at all.)</p> <p>Best wishes, and thanks as ever for your invaluable help</p>
04/05/2022 To: Katy Purvis From: Sheila Kent	<p>Here's Graham's letter and my query about one of the pews he mentions. (Forgive the typo - the electric piano is over 20 years old, not 30!)</p>
20/06/2022 To: Katy Purvis From: Sheila Kent With attachment	<p>Attached should be the revised information about the organ console at Siddington, as agreed between the Diocesan Organ Advisor and Philip Cartwright.</p> <p>4) Work Schedule and Specification of Philip Cartwright dated 10 June 2022</p>
07/07/2022 To: Katy Purvis From: Sheila Kent	<p>I was just wondering if there was any news about our organ plans?</p>
07/07/2022 To: Sheila Kent From: Katy Purvis	<p>File note of phone call</p> <p>Explained that the advice had not been sent as it had arisen from confusion over proposals at June DAC meeting, which came to light after the event and that Caroline and Bob were working out what to do about it</p>
02/08/2022 To: Caroline Hilton, Katy Purvis From: Sheila Kent	<p>The church officers of Siddington Church have asked me to contact you to express our disappointment and frustration at the lack of any formal response to our recent application to the DAC regarding the installation of a new organ console at All Saints, Siddington.</p> <p>As far as we are aware we have complied with all the DAC requirements, we know that we have the full support of the Diocesan Organ Advisor, our finances are entirely in place, no major structural alteration of any</p>

	kind Is required to carry out this work and we simply do not understand why the DAC have not had the consideration to respond to us.
02/08/2022 To: Sheila Kent From: Katy Purvis	<p>I'm sorry we haven't formally responded to you about the organ console.</p> <p>As we discussed, unfortunately the DAC misunderstood the proposals at the June meeting, and so the minutes of that meeting did not result in advice that would have been helpful to you in progressing the application. Therefore we did not send you the minuted informal advice after that meeting, but you and I had a later conversation, where I explained the problem and that the DAC Chair and Caroline, the DAC Secretary were having a discussion about how to resolve it.</p> <p>It was decided that a correction to the minutes should be discussed at the 22 July DAC Standing committee. Standing committee cannot recommend works to Grade 2* or Grade 1 churches, so it was not possible to progress the application at that meeting, only to explain to the sub-committee that the June meeting minutes for this case were based on misconception, to discuss the procedure for correction of the minutes and advice and how to proceed the case going forward.</p> <p>The minutes of the 22 July meeting were as follows</p> <p>The Sub-Committee <u>RESOLVED</u> that:</p> <ol style="list-style-type: none"> a. A note explaining the proposals had not been correctly understood and what the proposals actually comprise, explicitly identified as a note added after the meeting, would be added to the 24 June 2022 minutes b. In order for this matter not to be delayed to the next full meeting of the DAC on 9 September 2022, and given the relatively non-controversial nature of the proposals, the corrected proposal details would be circulated by email to the full DAC for its consideration and recommendation virtually <p>Caroline and I are both working from home today. I need to check with her in case there is any reason we cannot carry out the action above immediately. If there is not, then I will carry it out today. If there is a reason for delaying, I will let you know</p>