

Thank You

You will receive a warm welcome at any of St John's services or events. Details can be found in our monthly magazine. Please help yourself to a free copy of this month's magazine from the back of church, or check out the website - www.stjohnsandway.org.uk



BACK PAGE

St John's Church Sandiway

Welcome to St John's which has been a place of worship for over 100 years. Please feel free to look around.

This guide provides information to help you enjoy your visit. Please keep it as a souvenir when you have finished.



History

The church was designed by the well-known Cheshire architect John Douglas who was born in the village in 1830. He also gave the land on which the church stands and donated generously to the building of the chancel and the lychgate. The church is built from red sandstone from Frodsham Quarries. On the 12th April 1902 the foundation



stone was laid by the Earl of Mansfield. The stone can be seen on the outside wall underneath the east window. The date 1902 can also be seen inscribed over the vestry door.

The main part of the building was completed in 1903 and the church was dedicated by the Bishop of Chester, Dr Francis Jayne on 26th October 1903.

The church building gained listed building status in 1986.



The Building

As you approach the church through the lychgate the statue of St John the Evangelist can be seen on the north wall. The lychgate is also a listed building and was where a coffin could wait, on its bier, before being carried into the church. The tower with its embattled parapet can be seen as you walk up to the church porch. The



tower was designed by John Douglas but not built until after his death in 1911 once additional funds had been raised. Written above the porch is "*nisi dominus*" which is taken from the opening words of Psalm 127 - *Unless the Lord builds the house, the builders labour in vain*. On the left side of the porch is a small stained glass window, depicting Tobias



and the angel, made by Lavers & Westlake. As you enter the church there are also two other windows by them set into the west nave wall either side of the baptistry.

We praise you for all those people, past and present, who have served you faithfully.

O God our father, you take us from our busy world into the quiet of your house.

The Nave



After seeing the windows walk up the aisle through the nave, past the pews with carved ends. On the left you will see the carved oak pulpit built by John Sewell of Chester in 1904. The oak panels depict Jesus preaching, Jesus with a lantern and carrying a lamb, Jesus preaching and holding a banner

with the words "Ecce Agnus Dei" (Behold the Lamb of God), and two smaller panels. On the wall above the pulpit hangs a crucifix made in Oberammergau. A brass eagle lectern dated 1902 can be seen on the opposite side. The eagle is the symbol of John the Evangelist. Further to the right you will see an ornamental grill inserted in the opening in 1962 and gilded in 2014. It is made of iron and based on the design of the ancient pectoral cross of St Cuthbert.

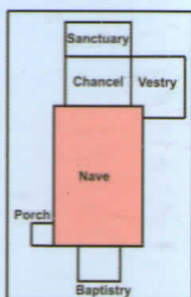

Open our hearts and our ears to hear your word and tell others the good news of Jesus.

The Chancel

Carry on up the two steps below the stone arch into the chancel. The choir stalls on the north wall of the chancel have carved back rests each with an inscription. Behind the opposite choir stalls is the organ.



Built by Wadsworth Brothers of Manchester in 1902, it was modernised by Rushworth and Dreaper Ltd in 1939. It is a two manual pedal organ, electrically blown. The casing is of carved oak with two angels and the inscription "O let the Earth bless the Lord, Ye, let it Praise Him and magnify Him for ever". Below the pipes there is a stone traceried arcade to the organ chamber. An opening to the right leads to the vestry.

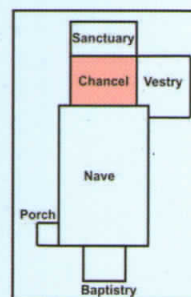

We praise you in the words we speak and the songs we sing and the lives we live.

The Sanctuary



Beyond the choir stalls lies the sanctuary. The Lord's Table is used during communion and is the original freestanding oak table. Behind and above the table you will see the lovely stained glass east window in all its glory. It depicts Christ crucified in the middle with David the Psalmist and the Virgin Mary on one side and St John the Evangelist and Moses on the other. The ceiling of the sanctuary is panelled in oak with foliage bosses. Suspended from the ceiling you will see the sanctuary light which represents God's presence. This light stays on at all times.

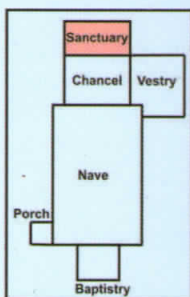
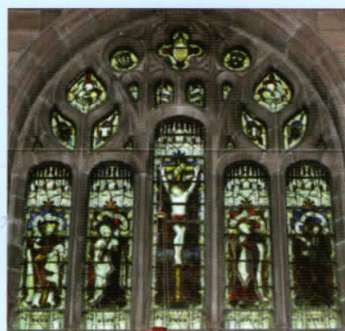

Make us humble, friendly, joyful and loving to all who enter this space.

The Baptistry

After viewing the chancel and sanctuary turn and go to the rear of the church. Here in the baptistry you will find the octagonal stone font. It is mounted on two steps and is inscribed "For thine is the Kingdom and the Power and the Glory for ever and ever, Amen". The cover is made of oak and topped with a cross of iron. The west stained glass window at the back, depicting Faith, Hope and Charity, was made by Gilbert Percival Gamon and donated by the Cheshire Hunt. The south window in the baptistry shows Jesus being baptised by John the Baptist with the quotation "This is my beloved Son in whom I am well pleased". Inset into the north wall is a blue glazed terracotta panel, made by the Della Robbia Company, of Jesus surrounded by children.

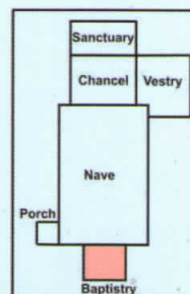

God of water, Lord of life we thank you for your love.